



March 10, 2021

City of Aurora  
Planning & Development Services  
Attention: Stephen Rodriguez, Planning Supervisor  
15151 E. Alameda Parkway, Suite 5200  
Aurora, Colorado 80012  
Ph: 303.739.7346

**Re: TransPort Colorado – Potable Water Tank  
Letter of Introduction  
Submittal #1**

TransPort Colorado is a proposed logistics and commerce park consisting of approximately 5,400 acres of industrial and mixed-use commercial development adjacent to the Colorado Air and Space Port, formerly known as Front Range Airport, in Aurora, Colorado. The project offers significant growth opportunity for the area due to its proximity to I-70, Highway 36, Denver International Airport, and the Union Pacific Rail line that borders the southern portion of the site.

The site is divided into 6 sub-areas with development starting in Sub-Area 1. Initial users within this sub-area will be served by a 1.5-million-gallon water tank until a connection to the city water system is made.

The proposed water tank site will range from 1.5 to 1.75 acres and is located on the south side of East 32nd Avenue west of Cavanaugh Road within Section 28. The roadway and utility improvements that will connect to the site are covered in the Infrastructure Site Plan for Filing 1 of Sub-Area 1.

The construction phases of the water tank site are anticipated to include full buildout of the 1.5-million-gallon tank, internal utilities, equipment pads and buildings. A Preliminary Plan/Site Plan will be submitted to show the preliminary design of the improvements needed to support development of the proposed site including:

- Drainage
- Landscaping
- Utilities
- Buildings
- Site Access

If you have any questions or concerns regarding this Site Plan, please feel free to contact me.

Sincerely,

Jennifer Carpenter  
Principal



March 10, 2021

City of Aurora  
Planning & Development Services  
Attention: Stephen Rodriguez, Planning Supervisor  
15151 E. Alameda Parkway, Suite 5200  
Aurora, Colorado 80012  
Ph: 303.739.7346

**Re: TransPort Colorado – Potable Water Tank**  
**Vicinity Map**  
**Submittal #1**

**VICINITY MAP**

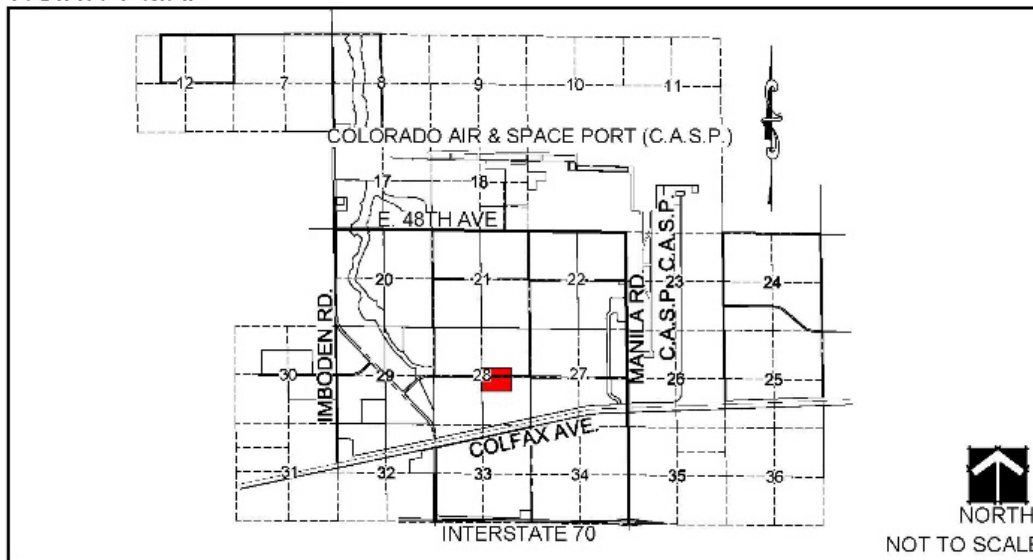

Sincerely,

Jennifer Carpenter  
Principal