

[A2.X floor plan.dwg] [A5.1 Sections.dwg]
Drawing name: M:\Current Projects\2020\2020-133 (Alt) 12203 E. Mississippi, Aurora, Co\01-Arch\A1.1 SITE PLAN.dwg May 07, 2021 -- 12:13pm

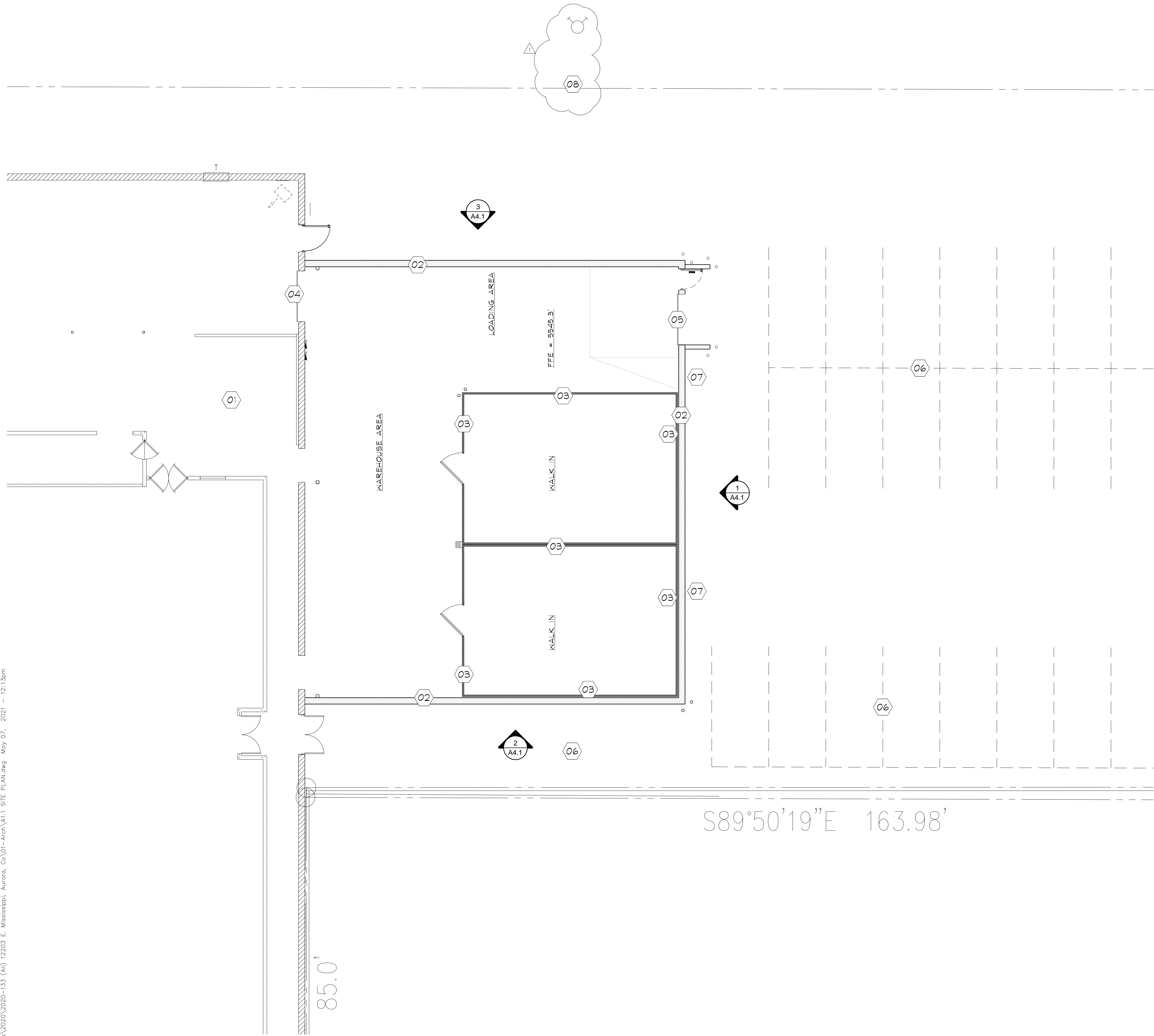

1
A4.2

ENLARGED SITE PLAN

SCALE 1/8" = 1'-0"

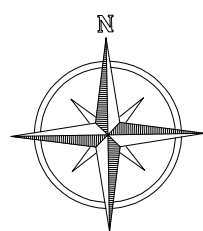

0 8 16 24

Graphic Scale: 1 inch = 8 feet

GENERAL SHEET NOTES / LEGEND:

GENERAL CONTRACTOR TO FIELD VERIFY ALL WORK REQUIRED FOR THIS PROJECT, COORDINATE ALL WORK WITH THE EXISTING TENANT AND THE CLIENT AS REQUIRED.

- 01 EXISTING RETAIL BUILDING TO REMAIN, FIELD VERIFY ALL CONDITIONS..
- 02 NEW ADDITION AND LOADING DOCK STRUCTURE FOR THIS PROJECT, RE: 1/A1.2, FIELD VERIFY ALL CONDITIONS.
- 03 NEW WALK IN COOLER AND FREEZER RE: MECHANICAL PLANS, FIELD VERIFY ALL CONDITIONS.
- 04 EXISTING DOCK DOOR TO REMAIN, FIELD VERIFY ALL CONDITIONS.
- 05 NEW DOCK DOOR, FIELD VERIFY ALL CONDITIONS.
- 06 EXISTING PARKING SPACES TO BE MODIFIED AS REQUIRED, FIELD VERIFY ALL CONDITIONS.
- 07 ROOF DRAINS TO BE CONNECTED TO THE STORM WATER SYSTEM AS REQUIRED RE: CIVIL GRADING PLAN, FIELD VERIFY ALL CONDITIONS.
- 08 PROVIDE THE REQUIRED FENCE GATE AND KNOX LOCK FOR THE LOCAL FIRE DEPARTMENTS REQUIREMENTS FOR ACCESS TO THE FIRE HYDRANT ACROSS THE PROPERTY LINE, FIELD VERIFY ALL CONDITIONS.

Wayne D. Anderson, AIA, LLC
7825 W. Ontario Place
Littleton, Colorado 80128
(303) 550-5678
(720) 367-5354 EFax

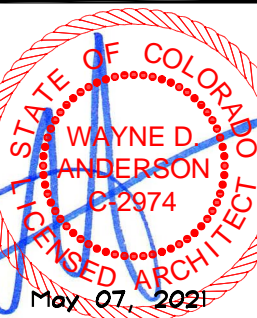
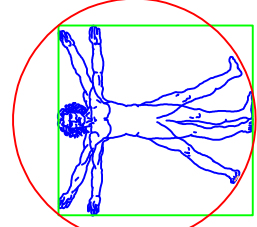

Warehouse Addition
12303 E. Mississippi, Unit 135
Aurora, Co

ISSUE DATE:

May 07, 2021

REVISIONS:

05-07-21

SCALE: 1/8"=1'-0"

PROJECT: 2020-132

ENLARGED
SITE PLAN

A1.2