

LONA

# Open Space And Circulation Plan

TAB 9

OPEN SPACE, CIRCULATION, AND NEIGHBORHOOD PLAN

FORM J: PARKS, RECREATION, AND OPEN SPACE MAP

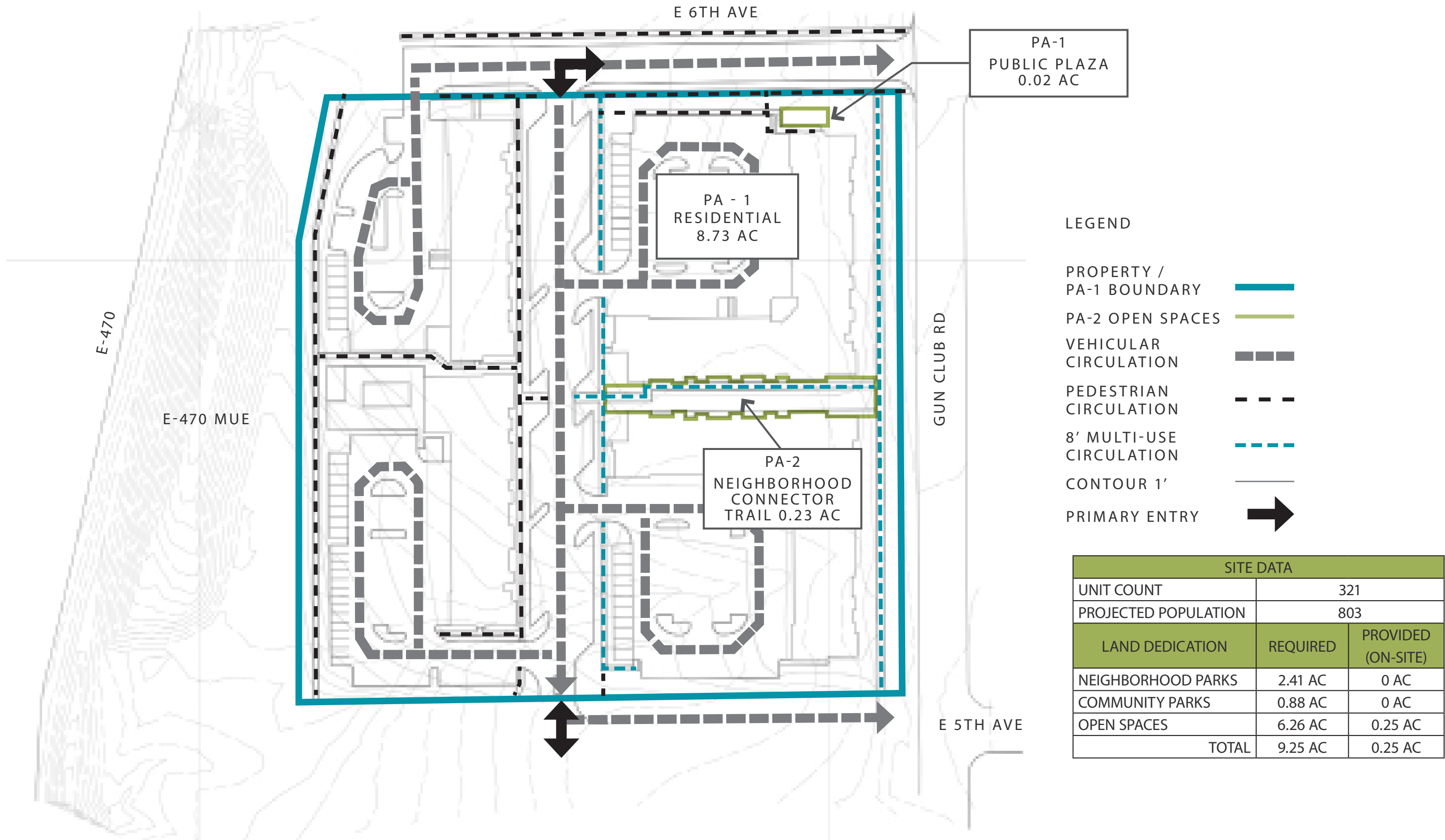

FORM J: PARKS, RECREATION, AND OPEN SPACE MATRIX

PLANNING AREA DESIGNATION	BRIEF DESCRIPTION OF THE FEATURE	TOTAL ACREAGE	PARKS DEPT. CREDITED ACREAGE	FINAL OWNERSHIP AND FACILITY FUNDING	TRIGGER FOR EACH PHASE
PA-2  PUBLIC PLAZA	<p>This Plaza area exceeds the UDO minimum required area of 600 SF, by providing approximately 890 SF that offers multiple functions in its use and design. The intent is to create a strong plaza element at the northeast corner of the property offering unique focal point for the pedestrians and vehicular traffic along Gun Club Road, while also providing a location for project identification and placemaking elements.</p> <p>The plaza area includes two picnic tables within a paved area and a multi-use crusher fines sport court, offering people a space to dine, sit and relax, and partake in leisurely lawn-style games</p>	0.02 AC	0.02 AC	Property Owner	Site To Be Constructed In A Single Phase
PA - 2  NEIGHBORHOOD CONNECTOR TRAIL	<p>The central amenity space of this project meets the neighborhood connector trail standards as outlined in the PROS Dedication and Development Criteria Manual, in that it serves as a route for residents to travel by foot or wheels from their homes to local, nearby destinations, making the connection from Gun Club Road to the E-470 Multi-Use Easement and associated Regional Trail.</p> <p>The trail corridor is required to have a 6-foot sidewalk and be a minimum of 26-feet wide; the proposed Neighborhood Connector Trail area provides an 8-foot walk and is a minimum of 30-feet wide.</p> <p>The design of the space includes programmatic elements as follows:</p> <ul style="list-style-type: none"><li>• 8-foot wide paths for pedestrians and cyclists, seating opportunities, landscaping, site furniture, bicycle support facilities (4 bike racks for 8 bike parking spaces total), and special pavement treatments.</li><li>• Open turf areas, a shade structure, and a hard surface sports and lawn game court.</li><li>• Pollinator habitat</li></ul>	0.23 AC	0.23 AC	Property Owner	Site To Be Constructed In A Single Phase
TOTAL		0.25 AC	0.25 AC	-	-

DIRECTOR OF PARKS, RECREATION AND OPEN SPACE

Date:\_\_\_\_\_ Signature: \_\_\_\_\_

Notes:

1. community park and neighborhood park dedications are to be made through cash-in-lieu.
2. detention areas which do not drain within 24 hours have not been included in total credited acreage.