

PUBLIC ART BUDGET

CITY OF AURORA ART FEE ALLOCATION	% OF TOTAL	ASSOCIATED FEES
Artist Design, Fabrication, Installation	75%	\$337,500
Public Art Plan Application Fee	5%	\$22,500
Project Coordinator	10%	\$45,000
Subtotal	90%	\$405,000
Future Maintenance & Repairs	10%	\$45,000
Total	100%	\$450,000
Total Project Budget	1%	\$45,000,000

PUBLIC ART GOALS

- Durable Materials
- Interactive
- Art Pieces to incorporate Lighting or be well lit
- Create a Unique Identity for the project
- Be Contemporary in Character
- Be done as a Series

PUBLIC ART POSSIBLE LOCATIONS

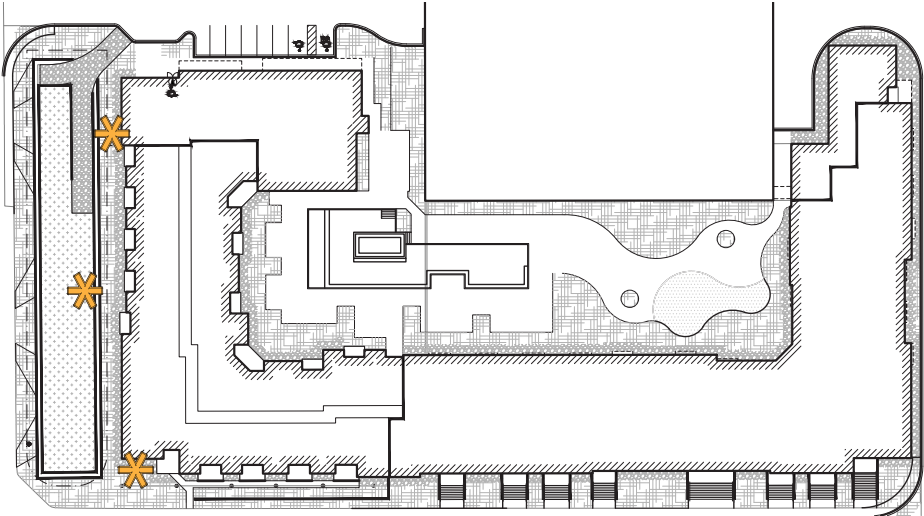

POSSIBLE LOCATION: *

PRELIMINARY THEME

In acknowledgment of the light-rail station directly across the street, the Public Art will be oriented to the west and provide passersby and residents with a visually-intriguing and potentially interactive offering. Considerations include:

- A mural on the east-facing retaining walls of the detention pond along Abilene
- A sculptural element incorporated into the SW corner of the building architecture
- A single or series of sculptures located at the W of the site near the entry plaza space

PRELIMINARY SCHEDULE

- Calls for entry will begin Q2 - Q3 of 2022
- Selection and design process will run concurrently with Aurora Entitlements Process
- Art implementation will begin after supportive and adjacent construction is completed, est. 2023

MATERIALS

Materials for Public Art are to coordinate with materials and modern aesthetic style of architecture. The building materials will include a mix of metal, concrete, wood and masonry. We envision any sculptural art to use durable materials such as metal and concrete. The style should be abstract and/or contemporary. The work(s) could be done by one Artist or an Artist Team. The incorporation of light for all of the art pieces is very important.

REPRESENTATIVE IMAGERY

