

COLORADO LAND SURVEY MONUMENT RECORD

007952

REPORT ONE MONUMENT ONLY ON THIS FORM
REPRODUCTION OF THIS FORM IS AUTHORIZED.

All items to be filled in by the Land Surveyor using permanent black lettering and lines which can be reproduced. (Except)*

1. TYPE OF MONUMENT (Check one) ☐ Section Corner ☐ Bench mark ☒ Quarter Corner ☐ Other _____

2. DESCRIPTION OF MONUMENT FOUND.

FOUND 3" BRASS CAP INSIDE CITY OF AURORA RANGE BOX,
L.S. 16419

3. DESCRIPTION OF MONUMENT ESTABLISHED BY YOU TO PERPETUATE THE LOCATION OF THIS POINT.

USED SWING TIES TO REFERENCE POINTS AS SHOWN BELOW.
TIES MATCH DATA SHEET PUBLISHED BY CITY OF AURORA.

4. SKETCH SHOWING RELATIVE LOCATION OF MONUMENT ACCESSORIES AND REFERENCE POINTS STATING WHETHER FOUND OR SET. SHOW SUPPORTING AND/OR CONTRADICTORY EVIDENCE WHERE APPLICABLE.

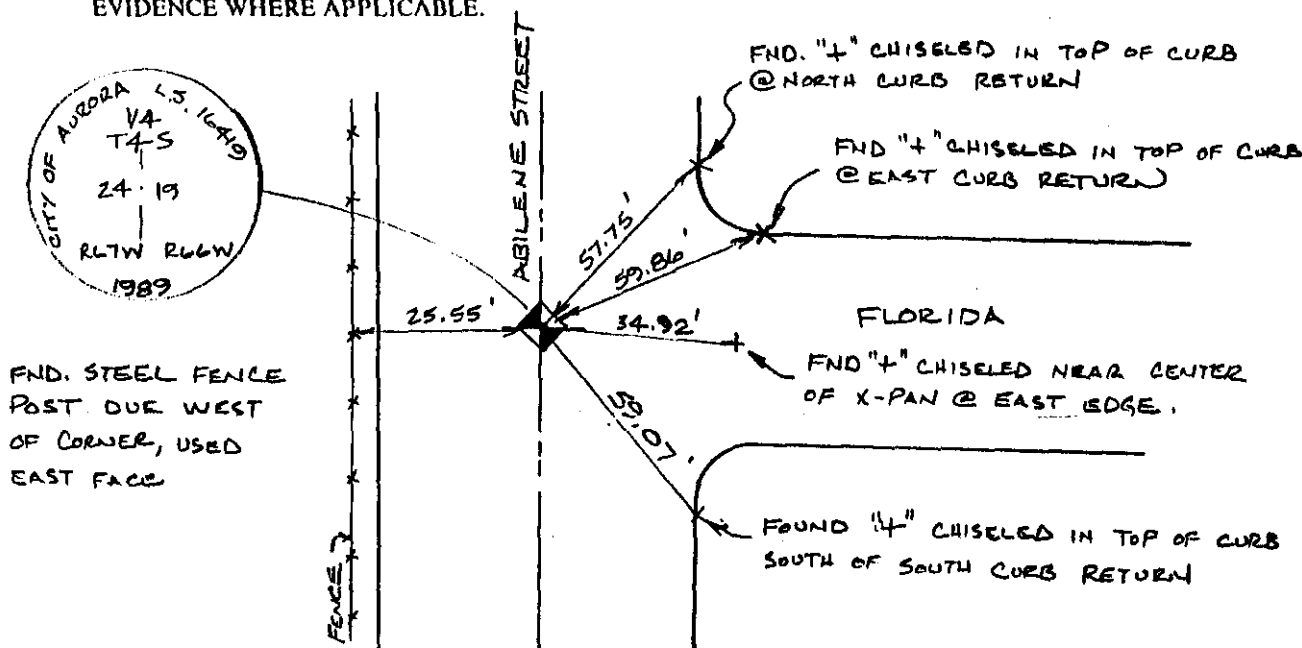

Date of Field Work MAY 20, 1989

5. CERTIFICATION

This is to certify that I was in responsible charge of the surveying work described in this record and that to the best of my knowledge the information presented herein is true and correct.

Date 9/23/89 Signature [Signature]
Firm Name: REAMS & PATTERSON, INC.
Phone: 745-4747

RECEIVED
SEP 4 1989
COLD SPRING
FOR PENDING

6. LOCATION DIAGRAM
1" = 1 Mile

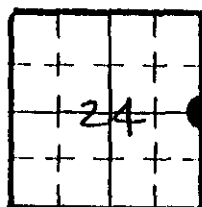

• = Location of Monument

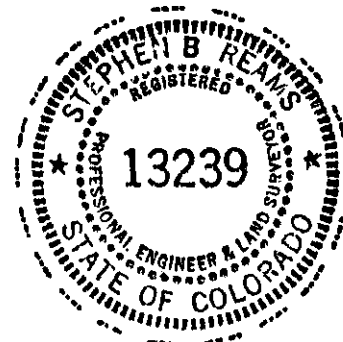

Surveyor's Seal

*(Do not fill in)
Accepted for Filing

State Board of Registration for Professional Engineers and Land Surveyors:
By [Signature]
Date SEP 8 1989

RECEIVED AT OFFICE OF THE COUNTY CLERK;

COUNTY
By _____
Date _____

Record to be filed by Index Reference Number, numerically, then alphabetically, under appropriate Township, Range, and Meridian.

7. SEC. 24, T 4S, R 67W, 6TH P.M.
COUNTY ARAPAHOE INDEX REF. NO. 25-L
8. SEC. 19, T 4S, R 66W, 6TH P.M.
COUNTY ARAPAHOE INDEX REF. NO. 1-L

COLORADO LAND SURVEY MONUMENT RECORD

Department of Regulatory Agencies
Board of Licensure for Architects, Professional Engineers and Professional Land Surveyors
1560 Broadway, Suite 1350
Denver, CO 80202
Phone (303) 894-7800; Fax (303) 894-2310; EMAIL aes@dora.state.co.us; V/TDD 711

OCT 28 2014

COLORADO ST. BD. OF LIC.

Report one monument only on this form - Reproduction of this form is authorized.

All items are to be filled in by the Land Surveyor using PERMANENT BLACK LETTERING and lines which can be reproduced.

1. TYPE OF MONUMENT: ☒ SECTION CORNER ☐ QUARTER CORNER ☐ SIXTEENTH CORNER ☐ OTHER _____

2. DESCRIPTION AND DATE OF MONUMENT FOUND: 9-17-2014 FD 3 1/4" ALUM. CAP
IN RANGE BOX Per Mon. Record By Don Lambert dated
Apr 30, 2003 & By J.R. AYERS Dated Sep 7, 1999. Construction
Activity in the Area For LIGHT RAIL OVER PASS.

3. DESCRIPTION OF MONUMENT SET BY YOU TO PERPETUATE THE LOCATION OF THIS POINT:
Established Accessory (cut 'X' in concrete) AS shown
below.

4. SKETCH SHOWING RELATIVE LOCATION OF MONUMENT, ACCESSORIES AND REFERENCE POINTS STATING
WHETHER FOUND OR SET, SHOW SUPPORTING AND/OR CONTRADICTIONARY EVIDENCE WHERE APPLICABLE:

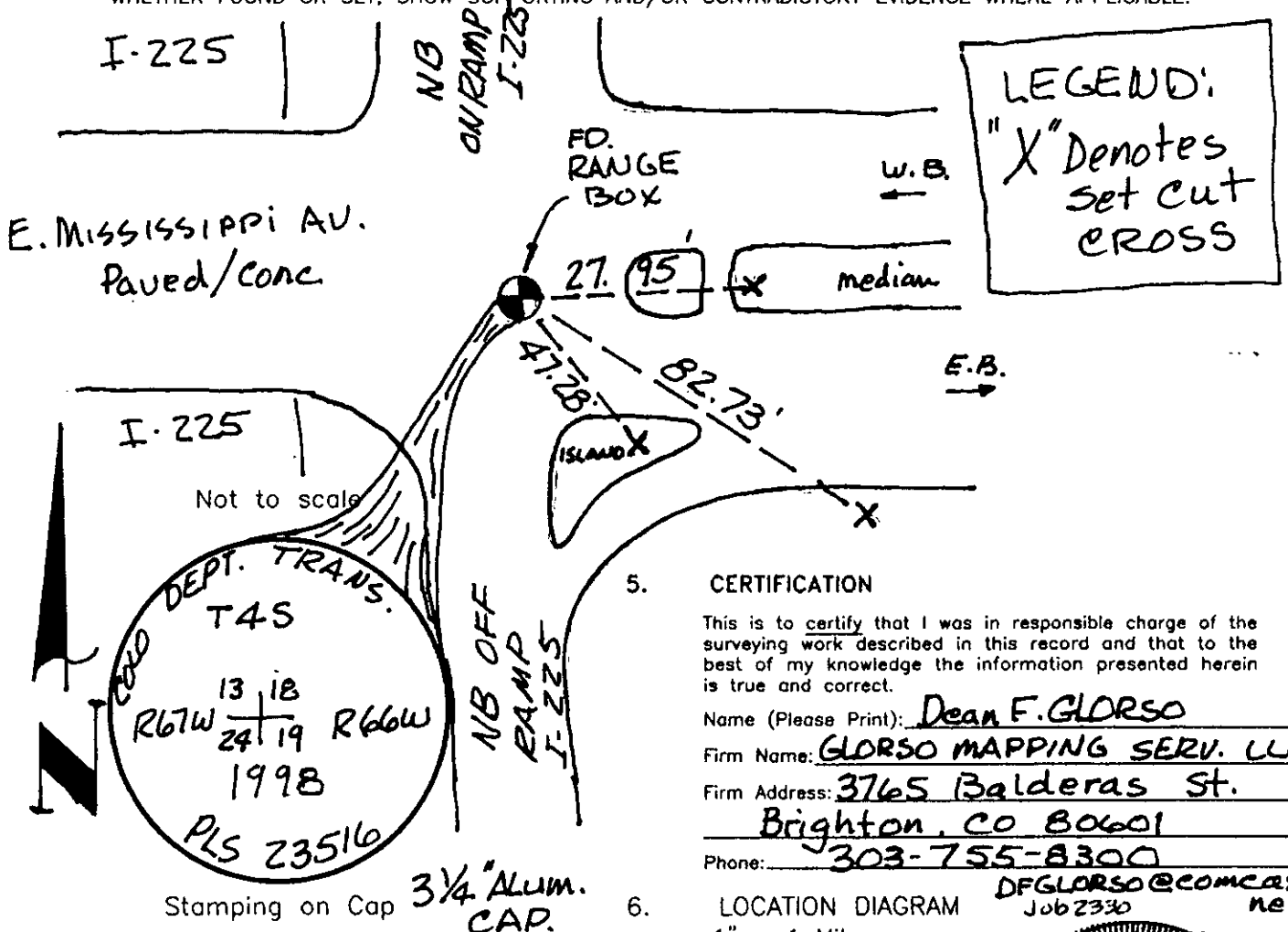

- a. Date of field Work to Establish, Restore or Rehabilitate Monument: _____
- b. Date Monument was used as a Control corner: 9-17-2014

(Surveyor, do not fill in)

ACCEPTED

NOV 30 2014

COLORADO ST. BD. OF LIC.
FORAES

RECEIVED AT OFFICE OF THE COUNTY CLERK
_____ COUNTY

BY: _____

DATE: _____

Record to be filed numerically by Index Reference Number, then alphabetically by letter in the index reference number, then under appropriate Township, Range, and Meridian.



DORA
Department of Regulatory Agencies