

AURORA TREE PLANTING NOTES

- EXCAVATE PLANTING HOLES WITH SLOPING SIDES. DO NOT DISTURB SOIL AT BOTTOM OF PLANTING HOLES, BUT DO SCORE THE SIDES OF THE PLANTING HOLE. MAKE EXCAVATIONS AT LEAST THREE TIMES AS WIDE AS THE ROOT BALL DIAMETER.
- TREES SHALL BE PLANTED WITH THE TOP MOST ROOT IN THE ROOT BALL 3" TO 5" HIGHER THAN THE FINISHED LANDSCAPE GRADE. THIS INCLUDES TREES THAT ARE SET ON SLOPES. SET ROOT BALL ON UNDISTURBED SOIL. TREES WHERE THE TRUNK FLARE IS NOT VISIBLE SHALL BE REJECTED. DO NOT COVER THE ROOT BALL WITH SOIL.
- CUT OFF BOTTOM 1/3 OF WIRE BASKET BEFORE PLACING TREE IN HOLE, CUT OFF REMAINDER OF BASKET AFTER TREE IS SET IN HOLE, REMOVE BASKET COMPLETELY. REMOVE ALL NYLON TIES, TWINE, ROPE AND BURLAP AS POSSIBLE. REMOVE UNNECESSARY PACKING MATERIAL.
- FORM SOIL INTO A 3" TO 5" TALL WATERING RING (SAUCER) AROUND PLANTING AREA. APPLY MULCH INSIDE WATERING RING.
- STAKING AND GUYING MUST BE REMOVED WITHIN 1 YEAR OR LESS OF PLANTING DATE.
- TREE WRAP IS NOT TO BE USED ON ANY NEW PLANTINGS, EXCEPT IN LATE FALL PLANTING SITUATIONS, AND ONLY THEN AFTER CONSULTATION WITH THE LANDSCAPE ARCHITECT.

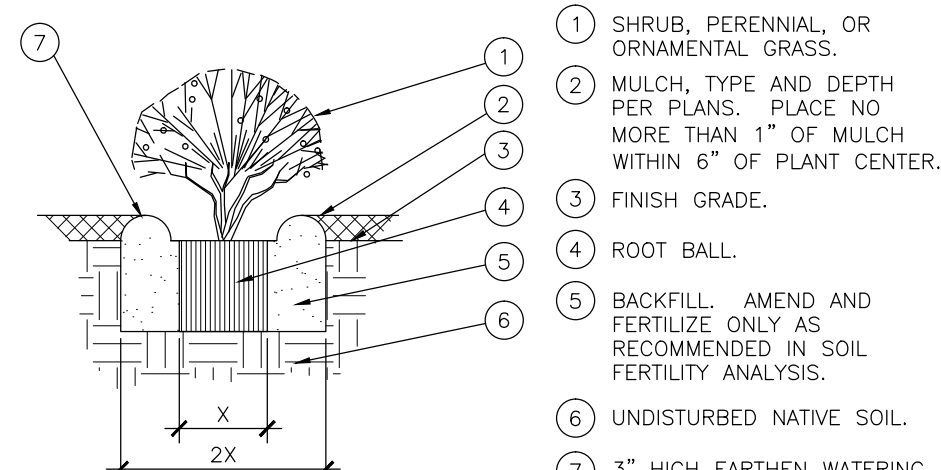

1 SHRUB AND PERENNIAL PLANTING
SCALE: NOT TO SCALE

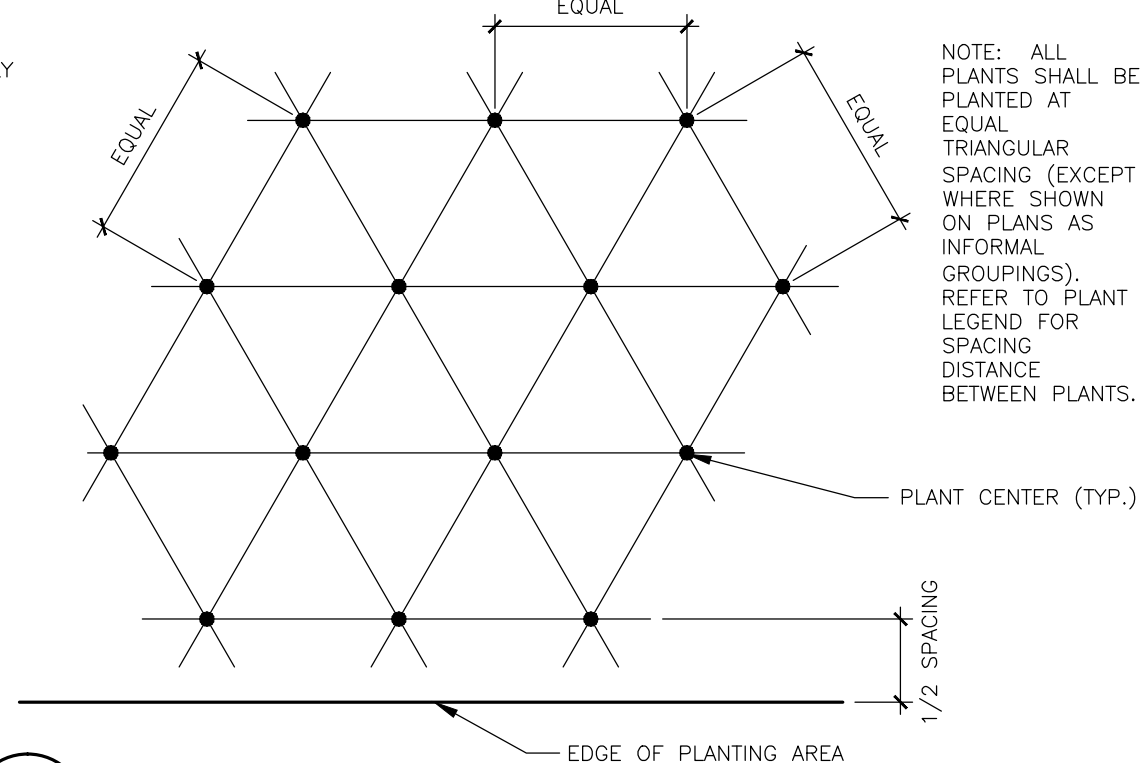

2 PLANT SPACING
SCALE: NOT TO SCALE

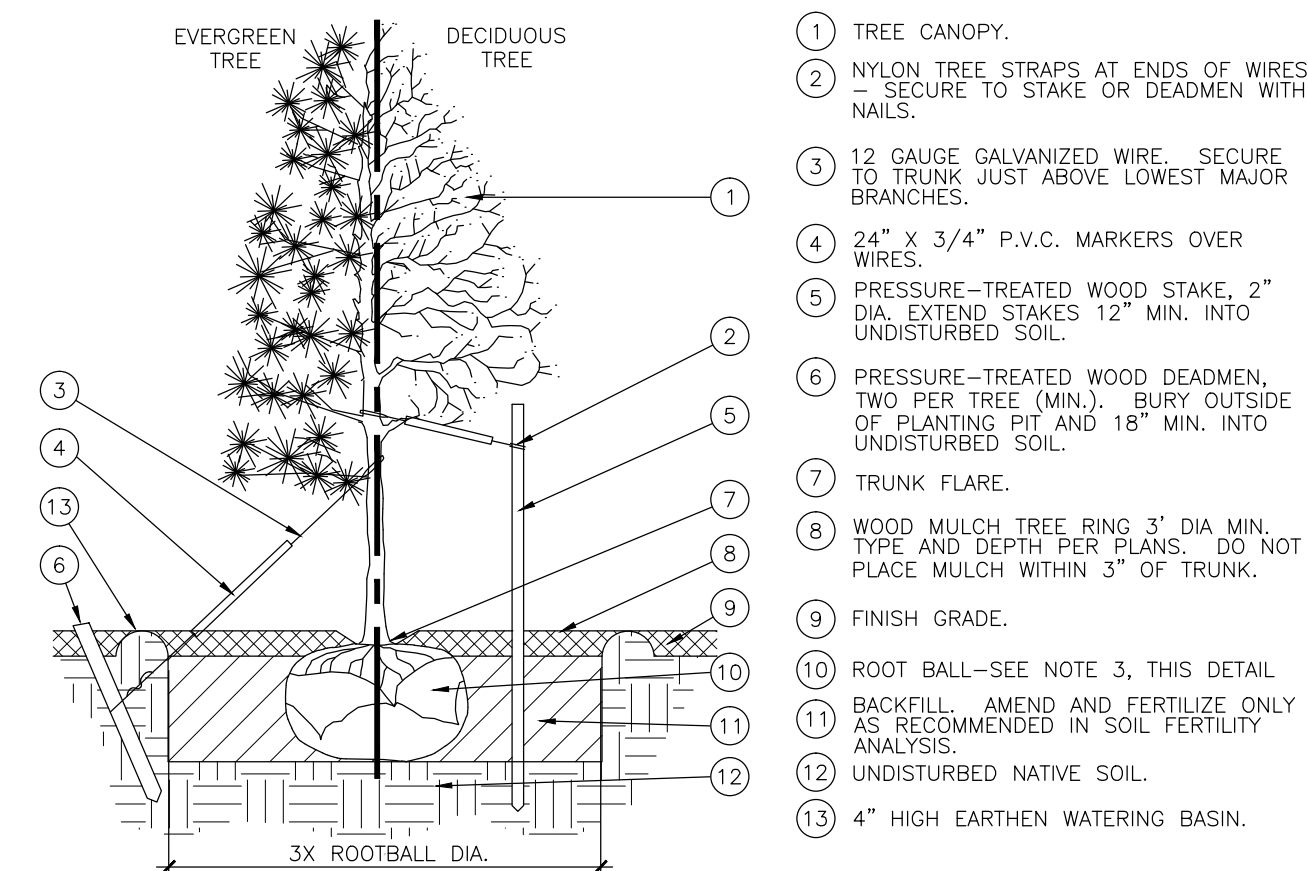

3 TREE PLANTING DETAIL
SCALE: NOT TO SCALE

SITE DATA TABLE:

TOTAL SITE AREA (OPEN SPACE):	22,653 SF (100%)
BUILDING COVERAGE:	180 SF
HARD SURFACE AREA:	18,296 SF
LANDSCAPE AREA:	4,356 SF (19%)
MAX % OF COOL SEASON GRASS ALLOWED:	1,452 SF (33%)
% OF COOL SEASON GRASS PROVIDED:	1,159 SF (27%)

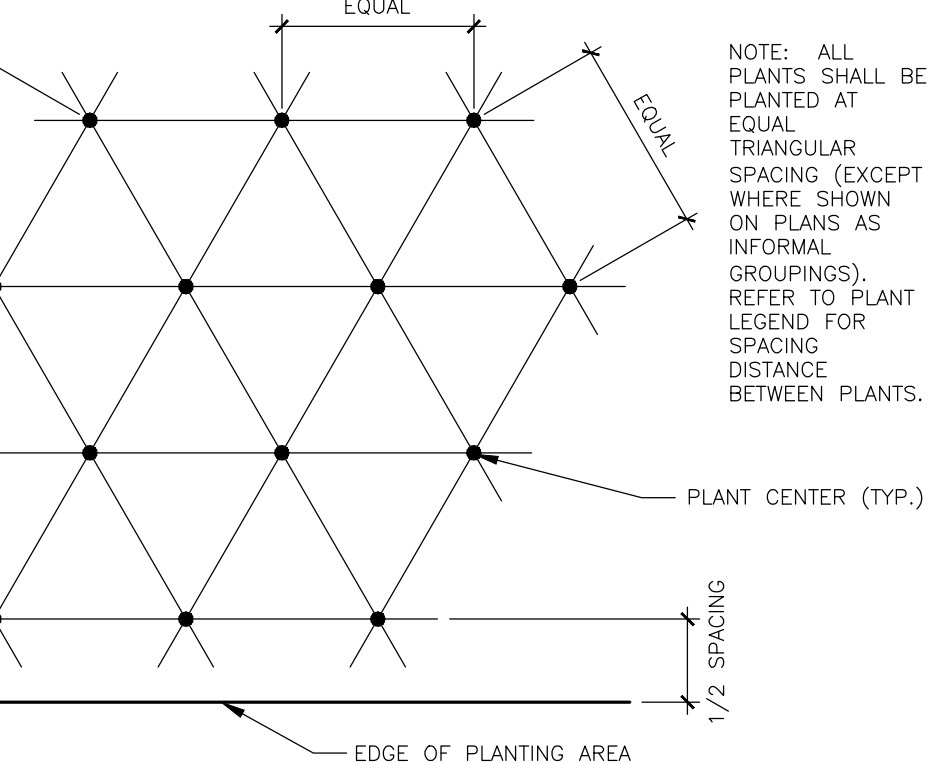

NOTE: ALL PLANTS SHALL BE PLANTED AT EQUAL TRIANGULAR SPACING (EXCEPT WHERE SHOWN ON PLANS AS INFORMAL GROUPINGS). REFER TO PLANT LEGEND FOR SPACING DISTANCE BETWEEN PLANTS.



STREET BUFFER TABLE:

STREET	AURORA CODE REQUIREMENTS	# OF TREES REQUIRED	# OF SHRUBS REQUIRED	# OF TREES PROPOSED	# OF SHRUBS PROPOSED	BUFFER WIDTH REQ./PROVIDED
BUCKLEY ROAD 136 LF	1 TREE EVERY 40 LF 10 SHRUB EVERY 40 LF	3 TREES	34 SHRUBS	2 NEW 5 EXISTING	23 SHRUBS 54 PERENNIALS	20'/11'-21'
TOTAL:		3 TREES	34 SHRUBS	5 TREES	23 SHRUBS 54 PERENNIALS	- - -

TREE PROTECTION NOTES

- CONTRACTOR TO FOLLOW CITY OF AURORA TREE PROTECTION REGULATIONS. CITY OF AURORA NOTES TAKE PRECEDENCE OVER NOTES BELOW.
- "PROTECTED ZONE" FOR EXISTING TREES: BEFORE BEGINNING ANY DEMOLITION OR CONSTRUCTION OPERATIONS, THE CONTRACTOR SHALL INSTALL TEMPORARY FENCING AROUND ALL EXISTING TREES WITHIN THE CONSTRUCTION ZONE THAT ARE TO BE SAVED. THE FENCE SHALL BE INSTALLED NO CLOSER TO THE TREE THAN THE EDGE OF THE TREE'S PROTECTED ZONE, GENERALLY DEFINED AS THE AREA BEGINNING FIVE FEET OUTSIDE OF THE TREE'S DRIPLINE AND EXTENDING TOWARDS THE TREE (OR AS FAR AWAY FROM THE TRUNK AS PRACTICABLE). THE FENCING SHALL BE OF A MATERIAL AND HEIGHT ACCEPTABLE TO THE LANDSCAPE ARCHITECT. ALL CONTRACTORS AND THEIR CREWS SHALL NOT BE ALLOWED INSIDE THIS "PROTECTED ZONE" NOR SHALL THEY BE ALLOWED TO STORE OR DUMP FOREIGN MATERIALS WITHIN THIS AREA. NO WORK OF ANY KIND, INCLUDING TRENCHING, SHALL BE ALLOWED WITHIN THE PROTECTED ZONE EXCEPT AS DESCRIBED BELOW. THE FENCING SHALL REMAIN AROUND EACH TREE TO BE SAVED UNTIL THE COMPLETION OF CONSTRUCTION OPERATIONS.
- TEMPORARY MULCH: TO ALLEVIATE SOIL COMPACTION IN ANTICIPATED AREAS OF HIGH CONSTRUCTION TRAFFIC, AND ONLY WHERE FENCING CANNOT BE SET FIVE FEET OUTSIDE OF THE DRIPLINE, THE CONTRACTOR SHALL INSTALL A LAYER OF MULCH, 9"-12" THICK, OVER ALL EXPOSED EARTH FROM THE TREE TRUNK TO 5' OUTSIDE OF THE DRIPLINE. THIS LAYER SHALL BE MAINTAINED AT ALL TIMES DURING CONSTRUCTION. WHEN PLANTING OPERATIONS ARE COMPLETED, THE MULCH SHALL BE REDISTRIBUTED THROUGHOUT ALL PLANTING AREAS IN A 3" THICK "PERMANENT" MULCH LAYER.
- NECESSARY WORK: WHEN IT BECOMES NECESSARY TO ENTER THE "PROTECTED ZONE", SUCH AS FOR FINE GRADING, IRRIGATION INSTALLATION, AND PLANTING OPERATIONS, THE CONTRACTOR SHALL STRICTLY ADHERE TO THE FOLLOWING RULES:
 - EVERY EFFORT SHALL BE MADE TO PRESERVE THE EXISTING GRADE AROUND PROTECTED TREES IN AS WIDE AN AREA AS POSSIBLE.
 - TRENCHING WITHIN THE PROTECTED ZONE OF EXISTING TREES SHALL BE PERFORMED BY HAND, AND WITH EXTREME CARE NOT TO SEVER ROOTS 1-1/2" IN DIAMETER AND LARGER. WHERE ROOTS 1-1/2" IN DIAMETER AND LARGER ARE ENCOUNTERED, THE CONTRACTOR SHALL TUNNEL UNDER SAID ROOTS. EXPOSED ROOTS THAT HAVE BEEN TUNNELED UNDER SHALL BE WRAPPED IN WET BURLAP AND KEPT MOIST WHILE THE TRENCH IS OPEN.
 - WHERE ROOTS 1-1/2" IN DIAMETER OR LARGER MUST BE CUT DUE TO EXTENSIVE GRADE CHANGES, THOSE ROOTS MUST BE EXPOSED BY HAND DIGGING AND CUT CLEANLY. RAGGED CUTS GENERALLY DO NOT HEAL PROPERLY, AND MAY LEAVE THE TREE OPEN TO PESTS AND PATHOGENS.
 - WHERE TRENCHING NEAR TREES HAS ALREADY OCCURRED FROM PREVIOUS CONSTRUCTION OPERATIONS, THE CONTRACTOR SHALL MAKE EVERY EFFORT TO CONFINE HIS TRENCHING OPERATIONS TO THE PREVIOUSLY-CREATED TRENCHES, WHILE ADHERING TO THE CONDITIONS SET FORTH IN 3B.
- POTENTIAL CONFLICTS: THE CONTRACTOR SHALL NOTIFY THE OWNER AND ARBORIST SHOULD ANY POTENTIAL CONFLICTS ARISE BETWEEN THESE SPECIFICATIONS AND/OR LARGE ROOTS ENCOUNTERED IN THE FIELD, AND CONSTRUCTION OPERATIONS. THE CONTRACTOR SHALL NOT TAKE ANY ACTION IN SUCH CONFLICTS WITHOUT THE ARBORIST'S WRITTEN APPROVAL. THE ARBORIST SHALL HAVE FINAL AUTHORITY OVER ALL METHODS NECESSARY TO HELP ENSURE THE PROTECTION AND SURVIVAL OF EXISTING TREES.
- PRUNING: PRUNE ONLY THE TREES THAT ARE INDICATED ON THE PLANS AS REQUIRING PRUNING. PRUNE TREES ACCORDING TO INTERNATIONAL SOCIETY OF ARBORICULTURE / ANSI A300 STANDARDS:
 - REMOVE ALL DEAD WOOD.
 - PRUNE LIVE WOOD FOR HEALTH OR STRUCTURAL REASONS ONLY, INCLUDING THE NEED TO ELIMINATE DISEASED OR DAMAGED GROWTH, ELIMINATE STRUCTURALLY UNSOUND GROWTH, REDUCE THE POTENTIAL FOR WIND TOPKILLING OR WIND DAMAGE, OR TO MAINTAIN GROWTH WITHIN LIMITED SPACE. DO NOT REMOVE MORE THAN 25% OF ANY TREE'S LIVE FOLIAGE IN ANY ONE GROWING SEASON. PRUNE ONLY TO INTERNATIONAL SOCIETY OF ARBORICULTURE/ANSI A300 STANDARDS, AND ONLY UNDER THE DIRECT SUPERVISION OF A CERTIFIED ARBORIST.
 - FINAL CUTS SHALL BE MADE JUST OUTSIDE THE SHOULDER RING AREA. EXTREMELY FLUSHED CUTS WHICH PRODUCE LARGE WOUNDS SHALL NOT BE MADE.
 - ALL TRIMMING CUTS SHALL BE PERFORMED IN SUCH A MANNER AS TO PROMOTE THE NATURAL GROWTH AND SHAPE OF EACH TREE SPECIES.
 - IMPROPER PRUNING METHODS INCLUDING, BUT NOT LIMITED TO, "TOPPING", "TIPPING", "HEADING BACK", "DEHORNING", and "LIONTAILING" WILL NOT BE ALLOWED. THE CONTRACTOR SHALL PAY FOR ALL WORK NECESSARY TO CORRECT SUCH PRUNING WHEN PERFORMED BY HIS CREWS OR SUBCONTRACTORS.
 - SHOULD THE CONTRACTOR REQUIRE MORE INFORMATION, THE CONTRACTOR SHALL CONTACT THE ISA AT (217) 355-9411 FOR A COPY OF THE ANSI A300 PRUNING STANDARDS. CONTRACTOR SHALL ADHERE TO THE METHODS AND PRACTICES SET FORTH IN THIS DOCUMENT.
- LANDSCAPE AND IRRIGATION (NATIVE TREES ONLY): ANY FUTURE LANDSCAPE AND IRRIGATION SHOULD ADHERE TO THE FOLLOWING GUIDELINES:
 - NO IRRIGATION OR PLANTING SHOULD OCCUR CLOSER THAN 6'-10" FROM THE TRUNK.
 - WHERE IRRIGATION DOES OCCUR WITHIN THE PROTECTED ZONE, DRIP IRRIGATION SHOULD BE USED WHEREVER POSSIBLE. ADDITIONALLY, ONLY PLANTS WITH LOW WATER NEEDS SHOULD BE PLANTED WITHIN THE PROTECTED ZONE, SPACED FAR APART WHERE CLOSE TO THE TREE. PLANTS MAY BE SPACED CLOSER TOGETHER NEAR THE EDGE OF THE PROTECTED ZONE.

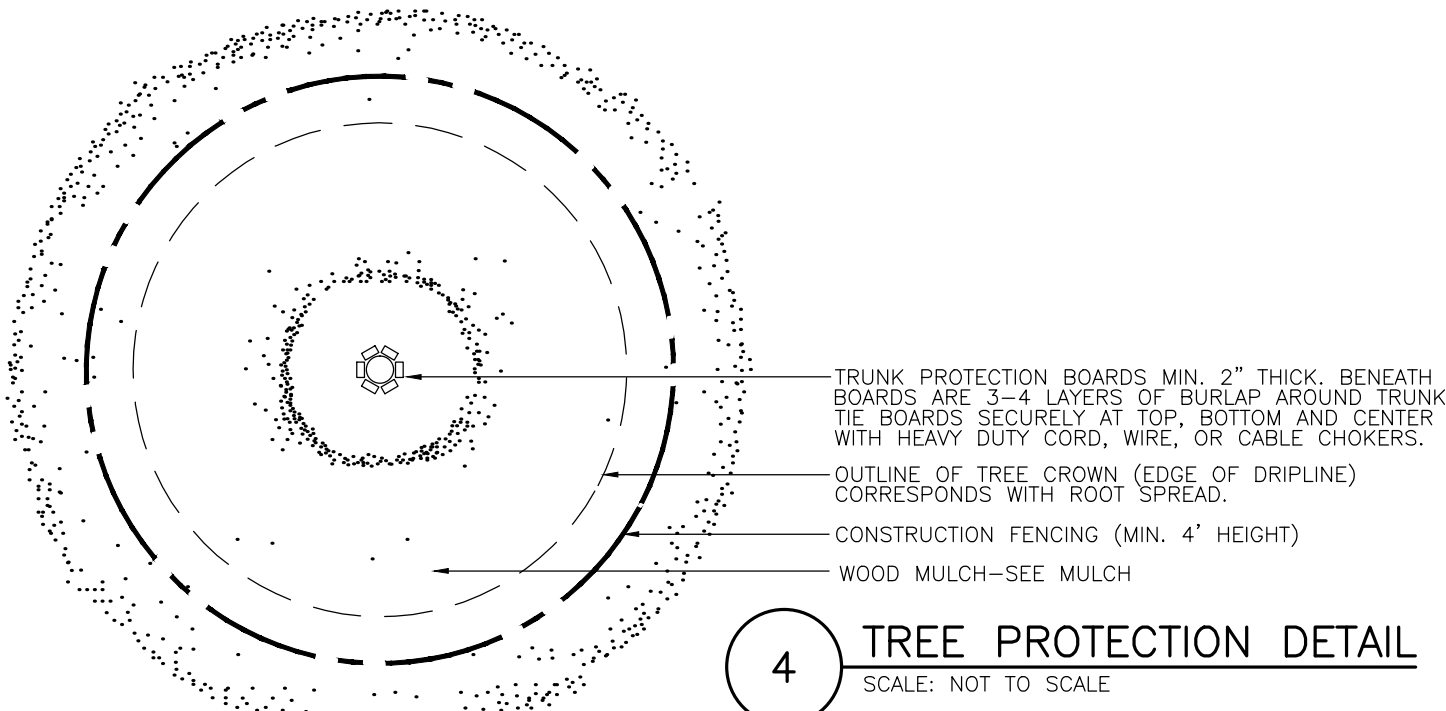

4 TREE PROTECTION DETAIL
SCALE: NOT TO SCALE

PLANTING LEGEND (BASED ON CITY OF AURORA LANDSCAPE MANUAL, ACC. ARTICLE 14 LANDSCAPE SECTION)

SYMBOL	QUANTITY	BOTANIC NAME	COMMON NAME	SIZE	WATER REQ.	HEIGHT X SPREAD
OVERSTORY DECIDUOUS TREES						
ACGR	2	ACER GRANDIDENTATUM 'SCHMIDT'	ROCKY MOUNTAIN GLOW MAPLE	2.5" CAL. B&B	LOW/MODERATE	30'X20'
GLTR	2	GLEDITSIA TRACANTHOS 'INERMIS SKYLINE'	SKYLINE LOCUST	2.5" CAL. B&B	LOW	50'X35'
DECIDUOUS SHRUBS						
PEAT	20	PEROVSKIA ARTILOCLOFOLIA	RUSSIAN SAGE	5 GALLON 12"-15"	LOW/MODERATE	4'x4'
RHAR	2	RHUS AROMATICA 'GRO-LOW'	GRO-LOW SUMAC	5 GALLON 12"-15"	LOW/MODERATE	2'x6'
RIAL	11	RIBES ALPINUM	ALPINE CURRANT	5 GALLON 12"-15"	LOW	4'x4'
EVERGREEN SHRUBS						
PIMU	6	PINUS MUGO 'SLOWMOUND'	SLOWMOUND MUGO PINE	5 GALLON 12"-15"	LOW	3'x3'
JUMA	4	JUNIPERUS X MEDIA	SEA GREEN JUNIPER	5 GALLON 18"-24"	LOW	8'x5'
JUNA	2	JUNIPERUS SABINA 'BUFFALO'	BUFFALO JUNIPER	5 GALLON 18"-24"	LOW	1'x6'
ORNAMENTAL GRASSES						
PAVI	28	PANICUM VIRGATUM 'SHANADOAH'	RED SWITCH GRASS	1 GALLON	LOW	3.5'X2.5'
SCSC	30	SCHIZACHYRIUM SCOPARIUM	LITTLE BLUESTEM	1 GALLON	LOW	3'X2'
PERENNIALS						
AQCH	30	AQUILEGIA CHRYSANTHA 'PAPRIKA'	PINK YARROW	1 GALLON	LOW	4'X2'
PEST	89	PENSTEMON STRICTUS	ROCKY MOUNTAIN PENSTEMON	1 GALLON	LOW	1.5'X1.5'
SEED, SOD, AND MULCH						
RTF	1,159 SF	RTF FESCUE SOD OR APPROVED EQUIVALENT SEE PLANTING NOTES	FESCUE SOD	1 GALLON	MODERATE	- - -
ROCK	2,597 SF	DOUBLE SHREDDED CEDAR MULCH W/ MULCH RING AROUND ALL PLANT MATERIAL. SEE PLANTING NOTES	ROCK MULCH	1 GALLON	KERISCAPES	- - -
EDG	150 LF	STEEL EDGING SEE PLANTING NOTES	PLANT BED EDGING	1 GALLON	- - -	- - -

NON-STREET FRONTAGE BUFFERS:

BUFFER DESCRIPTION	ADJACENT LAND USE	BUFFER REDUCTION FEATURES	BUFFER WIDTH REQ./PROVIDED	# OF TREES REQUIRED	# OF SHRUBS REQUIRED	# OF TREES PROPOSED	# OF SHRUBS PROPOSED
WESTERN BUFFER 150 LF	EXISTING COMMERCIAL	KERISCAPES RAINGARDEN	10'/3'-17'	3 TREES	17 SHRUBS	0 TREES	14 SHRUBS 119 PERENNIALS
NORTHERN BUFFER 150 LF			- - -	- - -	- - -	- - -	- - -
SOUTHERN BUFFER 150 LF			- - -	- - -	- - -	- - -	- - -
TOTAL:			- - -	3 TREES	17 SHRUBS	0 TREES	14 SHRUBS 119 PERENNIALS

LANDSCAPE GUARANTEE AND MAINTENANCE

- THERE SHALL BE A GUARANTEE ALL TREES, SHRUBS, PERENNIALS, SOD, SEEDS AREAS, AND IRRIGATION SYSTEMS FOR A PERIOD OF ONE YEAR FROM THE DATE OF THE OWNER'S ACCEPTANCE. THERE SHALL WILL REPLACEMENTS TO PLANTS WHICH DIE IN THAT TIME, OR REPAIR ANY PORTIONS OF THE IRRIGATION SYSTEM WHICH OPERATE IMPROPERLY.
- THERE WILL BE A MAINTENANCE AGREEMENT(S) TO MAINTAIN THE LANDSCAPE IN A NEAT, CLEAN, AND HEALTHY CONDITION FOR A PERIOD OF 90 DAYS. THIS SHALL INCLUDE PROPER PRUNING, MOWING AND AERATION OF LAWNS, WEEDING, REPLACEMENT OF MULCH, REMOVAL OF LITTER, AND THE APPROPRIATE WATERING OF ALL PLANTINGS. IRRIGATION SHALL BE MAINTAINED IN PROPER WORKING ORDER, WITH SCHEDULING ADJUSTMENTS BY SEASON AND TO MAXIMIZE WATER CONSERVATION. IF SITE OPENS DURING WINTER, TO AVOID FREEZE DAMAGE ON PLANTINGS, THE 90 DAYS SHOULD BEGIN AFTER ACCEPTANCE OF THE WORK.
- DURING THE LANDSCAPE MAINTENANCE PERIOD, ALL LANDSCAPE AREAS SHALL MAINTAIN POSITIVE DRAINAGE AWAY FROM STRUCTURES AT THE MINIMUM SLOPE SPECIFIED IN THE GEOTECHNICAL REPORT. LANDSCAPE AREAS WHICH SETTLE AND CREATE THE POTENTIAL FOR PONDING SHALL BE REPAIRED TO ELIMINATE PONDING POTENTIAL AND BLEND IN WITH THE SURROUNDING GRADES.

FIRE LIFE SAFETY LANDSCAPE NOTES

- LANDSCAPE MATERIAL PLACEMENT SHALL NOT BE PLACED OR KEPT NEAR FIRE HYDRANTS, FIRE DEPARTMENT INLET CONNECTIONS OR FIRE PROTECTION CONTROL VALVES IN A MANNER THAT WOULD PREVENT SUCH EQUIPMENT OR FIRE HYDRANTS FROM BEING IMMEDIATELY DISCERNIBLE. THE FIRE DEPARTMENT SHALL NOT BE DETERRED OR HINDERED FROM GAINING IMMEDIATE ACCESS TO FIRE PROTECTION EQUIPMENT OR HYDRANTS.
- A 5'-FOOT CLEAR SPACE SHALL BE MAINTAINED AROUND THE CIRCUMFERENCE OF FIRE HYDRANTS, LANDSCAPING MATERIAL SHOWN WITHIN THE SITE PLAN CANNOT ENROACH INTO ROADWAYS THAT ARE DEDICATED (OR DESIGNATED) AS FIRE LANE EASEMENTS (OR CORRIDORS).

PLANTING NOTES

GENERAL

- ALL WORK SHALL CONFORM TO ALL APPLICABLE STATE AND LOCAL CODES, STANDARDS, AND SPECIFICATIONS.
- LANDSCAPE DESIGN IS DIAGRAMMATIC IN NATURE. IN THE EVENT OF A DISCREPANCY BETWEEN THE PLAN AND THE LANDSCAPE LEGEND, THE PLANT QUANTITY AS SHOWN ON THE PLAN SHALL TAKE PRECEDENCE AND NOTIFY THE LANDSCAPE ARCHITECT OF THESE DISCREPANCIES. MINOR ADJUSTMENTS TO THE LANDSCAPE MATERIAL AND LOCATIONS MAY BE PROPOSED FOR CITY CONSIDERATION AT THE CONSTRUCTION DOCUMENT STAGE TO RESPOND TO MARKET AND FIELD CONDITIONS. HOWEVER, THERE SHALL BE NO REDUCTION IN THE NUMBER AND SIZE OF MATERIALS.
- ALL UTILITY EASEMENT SHALL REMAIN UNOBSTRUCTED AND FULLY ACCESSIBLE ALONG THEIR ENTIRE LENGTH FOR MAINTENANCE EQUIPMENT ENTRY.
- IF SITE CONDITIONS OR PLANT AVAILABILITY REQUIRE CHANGES TO THE PLAN, THEN AN APPROVAL WILL BE OBTAINED FROM THE CITY. DO NOT PROCEED UNTIL CONDITIONS HAVE BEEN CORRECTED.
- ALL CONSTRUCTION DEBRIS AND MATERIAL SHALL BE REMOVED AND CLEANED OUT PRIOR TO INSTALLATION OF TOPSOIL, TREES, SHRUBS, AND TURF.
- FOR ALL INFORMATION ON SURFACE MATERIAL OF WALKS, DRIVES, AND PARKING LOTS, SEE THE SITE PLAN. SEE PHOTOMETRIC PLAN FOR FREE STANDING LIGHTING INFORMATION.
- ALL LANDSCAPE CONSTRUCTION PRACTICES, WORKMANSHIP, AND ETHICS SHALL, BE IN ACCORDANCE WITH INDUSTRY STANDARDS SET FORTH IN THE CONTRACTORS HANDBOOK PUBLISHED BY THE COLORADO LANDSCAPE CONTRACTORS ASSOCIATION.
- LANDSCAPE AND IRRIGATION WORK SHALL BE COMPLETED PRIOR TO THE ISSUANCE OF THE FINAL CERTIFICATE OF OCCUPANCY.

FINISH GRADING AND SOIL PREPARATION

- MAINTAIN FINISH GRADES AS RECOMMENDED BY THE GEOTECHNICAL REPORT. ALL LANDSCAPE AREAS SHALL HAVE POSITIVE DRAINAGE AWAY FROM STRUCTURES AT THE MINIMUM SLOPE SPECIFIED IN THE REPORT, AND AREAS OF POTENTIAL PONDING SHALL BE RE-GRADED TO BLEND IN WITH THE SURROUNDING GRADES AND ELIMINATE PONDING POTENTIAL. SHOULD ANY CONFLICTS AND/OR DISCREPANCIES ARISE BETWEEN THE GEOTECHNICAL REPORT, THE GRADING PLANS, THESE NOTES, AND ACTUAL CONDITIONS, BRING SUCH ITEMS TO THE ATTENTION OF THE LANDSCAPE ARCHITECT AND OWNER.
- AFTER FINISH GRADES HAVE BEEN ESTABLISHED, IT IS RECOMMENDED SOIL SAMPLES SHOULD TESTED BY AN ESTABLISHED SOIL TESTING LABORATORY FOR THE FOLLOWING: GENERAL SOIL FERTILITY, PH, ORGANIC MATTER CONTENT, SALT (EC), LIME, SODIUM ADSORPTION RATIO (SAR) AND BORON CONTENT. EACH SAMPLE SUBMITTED SHALL CONTAIN NO LESS THAN ONE QUART OF SOIL. SUBMIT THE PROJECT'S PLANT LIST TO THE LABORATORY ALONG WITH THE SOIL SAMPLES. THE SOIL REPORT PRODUCED BY THE LABORATORY SHALL CONTAIN RECOMMENDATIONS FOR THE FOLLOWING (AS APPROPRIATE): GENERAL SOIL PREPARATION AND BACKFILL MIXES, FIRE-PLANT FERTILIZER APPLICATIONS, AND ANY OTHER SOIL RELATED ISSUES. THE REPORT SHALL ALSO PROVIDE A FERTILIZER PROGRAM FOR THE ESTABLISHMENT PERIOD AND FOR LONG-TERM MAINTENANCE.
- AT A MINIMUM, ALL TOPSOIL SHALL BE AMENDED WITH NITROGEN STABILIZED ORGANIC AMENDMENT COMPOST AT A RATE OF 4.0 CUBIC YARDS AND AMMONIUM PHOSPHATE 16-20-0 AT A RATE OF 15 POUNDS PER THOUSAND SQUARE FEET OF LANDSCAPE AREA. COMPOST SHALL BE MECHANICALLY INTEGRATED INTO THE TOP 6" OF SOIL BY MEANS OF ROTOTILLING AFTER CROSS-RIPPING. PERENNIAL BED AREAS SHALL BE AMENDED AT A RATE OF 8 CUBIC FEET PER THOUSAND SQUARE FEET OF NITROGEN STABILIZED ORGANIC AMENDMENT AND 10 LBS. OF 12-12-12 FERTILIZER PER CU. YD., ROTOTILLED TO A DEPTH OF 8". NO MANURE OR ANIMAL-BASED PRODUCTS SHALL BE USED FOR ORGANIC AMENDMENTS.

PLANTING

- ALL DECIDUOUS TREES SHALL HAVE WELL-SHAPED HEADS/ALL EVERGREENS SHALL BE UNSHEARED AND FULL TO THE CROWN, UNLESS OTHERWISE SPECIFIED. TREES WITH CENTRAL LEADERS WILL NOT BE ACCEPTED IF LEADER IS DAMAGED OR REMOVED. PRUNE ALL DAMAGED TWIGS AFTER PLANTING.
- ALL PLANTS WITHIN A SPECIES SHALL HAVE SIMILAR SIZE, AND SHALL BE OF A FORM TYPICAL FOR THE SPECIES. ANY PLANT DEEMED UNACCEPTABLE BY THE LANDSCAPE ARCHITECT SHALL BE IMMEDIATELY REMOVED FROM THE SITE AND SHALL BE REPLACED WITH AN ACCEPTABLE PLANT OF LIKE TYPE AND SIZE. ANY PLANTS APPEARING TO BE UNHEALTHY, EVEN IF DETERMINED TO STILL BE ALIVE, SHALL NOT BE ACCEPTED. THE LANDSCAPE ARCHITECT SHALL BE THE SOLE JUDGE AS TO THE ACCEPTABILITY OF PLANT MATERIAL.
- ALL TREES SHALL BE GUYED AND WOOD STAKED AS PER DETAILS. NO "T-STAKES" SHALL BE USED FOR TREES.
- ALL PLANT MATERIALS SHALL BE TRUE TO TYPE, SIZE, SPECIES, QUALITY, AND FREE OF INJURY, BROKEN ROOT BALLS, PESTS, AND DISEASES, AS WELL AS CONFORM TO THE MINIMUM REQUIREMENTS DESCRIBED IN THE "AMERICAN STANDARD FOR NURSERY STOCK" ANZI 60.1-2004, AMERICAN LANDSCAPE NURSERY ASSOCIATION, CURRENT EDITION. FOLLOW GREENCO TREE PLANTING RECOMMENDATIONS FOR MINIMUM QUALITY REQUIREMENTS FOR TREES.
- ALL TREE AND SHRUB BED LOCATIONS ARE TO BE STAKED OUT ON SITE FOR APPROVAL BY THE LANDSCAPE ARCHITECT PRIOR TO INSTALLATION.
- ALL TREES PLANTED ADJACENT TO PUBLIC AND/OR PEDESTRIAN WALKWAYS SHALL BE PRUNED CLEAR OF ALL BRANCHES BETWEEN GROUND AND A HEIGHT OF EIGHT (8) FEET FOR THAT PORTION OF THE PLAN LOCATED OVER THE SIDEWALK AND/OR ROAD.
- ALL TURF IS RECOMMENDED THROUGH GREEN VALLEY TURF COMPANY, 13159 N. US HIGHWAY 85, LITTLETON, CO 80125, (303) 798-6764. RTF SOD HAS BEEN APPROVED IN MANY JURISDICTIONS TO BE A LOW HYDROZONE PLANT MATERIAL. INSTALL AND MAINTAIN IN ACCORDANCE WITH MANUFACTURER'S SPECIFICATIONS.
- ALL PLANT MATERIAL SHALL NOT BE PLANTED PRIOR TO INSTALLATION OF TOPSOIL.
- ALL PLANT BEDS SHALL BE CONTAINED WITH STEEL EDGER. STEEL EDGER IS NOT REQUIRED ALONG CURBS, WALKS OR BUILDING FOUNDATIONS. ALL EDGING SHALL OVERLAP AT JOINTS A MINIMUM OF 6-INCHES, AND SHALL BE FASTENED WITH A MINIMUM OF 4 PINS PER EACH 10 FOOT SECTION. THE TOP OF ALL EDGING MATERIAL SHALL BE A ROLLED TOP AND 1/2" INCH ABOVE THE FINISHED GRADE OF ADJACENT LAWN OR MULCH AREAS. COLOR: GREEN.
- THE DEVELOPER, HIS SUCCESSOR, OR ASSIGNEE SHALL BE RESPONSIBLE FOR ESTABLISHING AND CONTINUING A REGULAR PROGRAM OF MAINTENANCE FOR ALL LANDSCAPED AREAS. SEE LANDSCAPE GUARANTEE AND MAINTENANCE NOTE.
- ALL LANDSCAPED AREAS AND PLANT MATERIAL, EXCEPT FOR NON-IRRIGATED NATIVE, RESTORATIVE, AND DRYLAND GRASS AREAS THAT COMPLY WITH REQUIREMENTS FOUND IN SEC. 146-1429, MUST BE WATERED BY AN AUTOMATIC UNDERGROUND IRRIGATION SYSTEM. IRRIGATION SYSTEM DESIGN, INSTALLATION, OPERATION, AND MAINTENANCE SHALL CONFORM TO REQUIREMENTS FOUND IN THE CITY OF AURORA IRRIGATION ORDINANCE.
- ALL TREES THAT OVERHANGS INTO THE FIRE LANE EASEMENTS SHALL BE TRIMMED UP TO A HEIGHT OF 13'-6".
- THE DEVELOPER, HIS SUCCESSORS AND ASSIGNS, SHALL BE RESPONSIBLE FOR INSTALLATION, MAINTENANCE AND REPLACEMENT OF ALL LANDSCAPING MATERIALS SHOWN OR INDICATED ON THE APPROVED SITE PLAN OR LANDSCAPE PLAN ON FILE IN THE PLANNING DEPARTMENT. ALL LANDSCAPING WILL BE INSTALLED AS DELINEATED ON THE PLAN, PRIOR TO ISSUANCE OF CERTIFICATES OF OCCUPANCY.
- LANDSCAPE MATERIAL PLACEMENT SHALL NOT BE PLACED OR KEPT NEAR FIRE HYDRANTS, FIRE DEPARTMENT INLET CONNECTIONS OR FIRE PROTECTION CONTROL VALVES IN A MANNER THAT WOULD PREVENT SUCH EQUIPMENT OR FIRE HYDRANTS FROM BEING IMMEDIATELY DISCERNIBLE. THE FIRE DEPARTMENT SHALL NOT BE DETERRED OR HINDERED FROM GAINING IMMEDIATE ACCESS TO FIRE PROTECTION EQUIPMENT OR HYDRANTS.
- ALL FIRE HYDRANTS WILL BE LOCATED NOT LESS THAN THREE FEET SIX INCHES (3' 6") AND NOT MORE THAN EIGHT (8') FEET FROM THE BACK OF CURB TO THE CENTER OF THE HYDRANT, UNOBSTRUCTED ON THE STREET SIDE WITH A MINIMUM CLEARANCE ON ALL OTHER SIDES OF FIVE (5') FEET.
- LANDSCAPING MATERIAL SHOWN WITHIN THE SITE PLAN CANNOT ENROACH INTO ROADWAYS THAT ARE DEDICATED (OR DESIGNATED) AS FIRE LANE EASEMENTS (OR CORRIDORS).

MULCHING

- ALL MULCH IS RECOMMENDED THROUGH SANTA FE SAND AND GRAVEL, 6601 S SANTA FE DRIVE, LITTLETON, CO 80120, (303) 794-5960
- AFTER ALL PLANTING IS COMPLETE, INSTALL A MINIMUM 4" THICK LAYER OF MULCH AS SPECIFIED IN THE PLANTING LEGEND. INSTALL A 4" THICK RING OF DOUBLE SHREDDED CEDAR MULCH AROUND ALL PLANTING AREAS. IN ROCK MULCH BEDS WHERE LANDSCAPING IS SHOWN ON THE PLANS, WOOD MULCH RING SIZE SHALL BE 1.5 X THE CONTAINER OF THE SHRUBS, PERENNIALS, AND ORNAMENTAL GRASSES. TREE RING SIZE SHALL BE GREEN INDUSTRIES OF COLORADO INDUSTRY STANDARD WIDTH.
- ALL MULCH SHALL BE HARVESTED IN A SUSTAINABLE MANNER FROM A LOCAL SOURCE.
- INSTALL DEWITT PRO-5 WEED BARRIER FABRIC UNDER ALL ROCK MULCH SHRUB BEDS SPECIFIED ON THE PLANS ONLY. NO LANDSCAPE FABRIC SHALL BE USED IN WOOD MULCH AREAS. NO PLASTIC WEED BARRIERS SHALL BE SPECIFIED.
- ABSOLUTELY NO EXPOSED GROUND SHALL BE LEFT SHOWING ANYWHERE ON THE PROJECT AFTER MULCH HAS BEEN INSTALLED.
- ALL PLANTING AREAS WITH LESS THAN A 4:1 GRADIENT SHALL RECEIVE A LAYER OF MULCH, TYPE AND DEPTH PER PLANS. SUBMIT 1 CUBIC FOOT SAMPLE OF MULCH (ONE SAMPLE PER TYPE) TO LANDSCAPE ARCHITECT FOR APPROVAL PRIOR TO PLANTING. THE MULCH SHALL BE SPREAD EVENLY THROUGHOUT ALL PLANTING AREAS, EXCEPT SLOPES 4:1 OR STEEPER, OR AS OTHERWISE DENOTED ON THE PLAN. ABSOLUTELY NO EXPOSED GROUND SHALL REMAIN IN AREAS TO RECEIVE MULCH AFTER MULCH HAS BEEN INSTALLED.
- ALL PLANTING AREAS ON SLOPES OVER 4:1 SHALL RECEIVE COCONUT FIBER EROSION CONTROL NETTING FROM ROLLS. NETTING SHALL BE #OT-125, AS MANUFACTURED BY NORTH AMERICAN GREEN (OR EQUAL). INSTALL AND STAKE PER MANUFACTURER'S SPECIFICATIONS. SEE ALSO THE CIVIL ENGINEER'S EROSION CONTROL PLAN.

IRRIGATION CONCEPT

- A IRRIGATION PLAN SHALL BE SUBMITTED AFTER THE APPROVAL OF THE LANDSCAPE CONSTRUCTION DOCUMENTS.
- ALL LANDSCAPED AREAS AND PLANT MATERIAL, EXCEPT FOR NON-IRRIGATED NATIVE, RESTORATIVE, AND DRYLAND GRASS AREAS THAT COMPLY WITH REQUIREMENTS FOUND IN SEC. 146-1429 AND/OR SEC. 146-1435 MUST BE WATERED BY AN AUTOMATIC UNDERGROUND IRRIGATION SYSTEM. IRRIGATION SYSTEM DESIGN, INSTALLATION, OPERATION, AND MAINTENANCE SHALL CONFORM TO REQUIREMENTS FOUND IN THE CITY OF AURORA IRRIGATION ORDINANCE.
- AN AUTOMATIC IRRIGATION SYSTEM SHALL BE INSTALLED AND OPERATIONAL BY THE TIME OF FINAL INSPECTION. THE ENTIRE IRRIGATION SYSTEM SHALL BE INSTALLED BY A QUALIFIED IRRIGATION CONTRACTOR.
- THE IRRIGATION SYSTEM WILL OPERATE ON POTABLE WATER, AND THE SYSTEM WILL HAVE APPROPRIATE BACKFLOW PREVENTION DEVICES INSTALLED TO PREVENT CONTAMINATION OF THE POTABLE SOURCE.
- ALL NON-TURF PLANTED AREAS WILL BE DRIP IRRIGATED. SODDED AREAS SHALL BE IRRIGATED WITH SPRAY OR ROTOR HEADS AT 100% HEAD-TO-HEAD COVERAGE.
- ALL PLANTS SHARING SIMILAR HYDROZONE CHARACTERISTICS SHALL BE PLACED ON A VALVE DEDICATED TO PROVIDE THE NECESSARY WATER REQUIREMENTS SPECIFIC TO THAT HYDROZONE.
- THE IRRIGATION SYSTEM SHALL BE DESIGNED AND INSTALLED, TO THE MAXIMUM EXTENT POSSIBLE, TO CONSERVE WATER BY USING THE FOLLOWING DEVICES AND SYSTEMS: MATCHED PRECIPITATION RATE TECHNOLOGY ON ROTOR AND SPRAY HEADS (WHEREVER POSSIBLE), RAIN SENSORS, AND MULTI-PROGRAM COMPUTERIZED IRRIGATION CONTROLLERS FEATURING SENSORY INPUT CAPABILITIES.
- IRRIGATION BACKFLOW PREVENTER SHALL BE SCREENED BY LANDSCAPING. IRRIGATION CONTROLLER SHALL BE SCREENED BY LANDSCAPING IN A VANDAL PROOF LOCKABLE CABINET OR LOCATED WITHIN THE BUILDING UTILITY CLOSET.

Project No: KSF000049.02
Sheet Scale: 1"=20'
Designed By: JLW
Drawn By: TDN
Date: MARCH 2, 2015
Disk File: KSF049_P_07-Land

LANDSCAPE PLAN

4 OF 8

Project No: KSF000049.02
Sheet Scale: 1"=20'
Designed By: JLW
Drawn By: TDN
Date: MARCH 2, 2015
Disk File: KSF049_P_07-Land

KING SOOPERS
Supermarket
Petroleum
Fuels
King Soopers
2351 SOUTH BUCKLEY ROAD
AURORA, COLORADO

Galloway
Planning, Architecture, Engineering
6162 South Willow Drive, Suite 320
Denver, CO 80223
Phone: (303) 770-8866
Fax: (303) 971-7596
www.gallowayus.com