

K:\DEV_Civil\096648001_E4170_1\Drawings\Site\Aurora\096648001_P1.dwg Drawn By: NER 9/9/2020 4:03 PM
THIS DOCUMENT CONTAINS THE CONCEPTS AND DESIGN PRESENTED HEREIN AS AN INSTRUMENT OF SERVICE. IT IS INTENDED ONLY FOR THE SPECIFIC PROJECT AND CLIENT FOR WHICH IT WAS PREPARED. REUSE OF AND IMPROPER RELIANCE ON THIS DOCUMENT WITHOUT WRITTEN AUTHORIZATION AND ADAPTATION BY KIMLEY-HORN AND ASSOCIATES, INC. SHALL BE WITHOUT LIABILITY TO KIMLEY-HORN AND ASSOCIATES, INC.

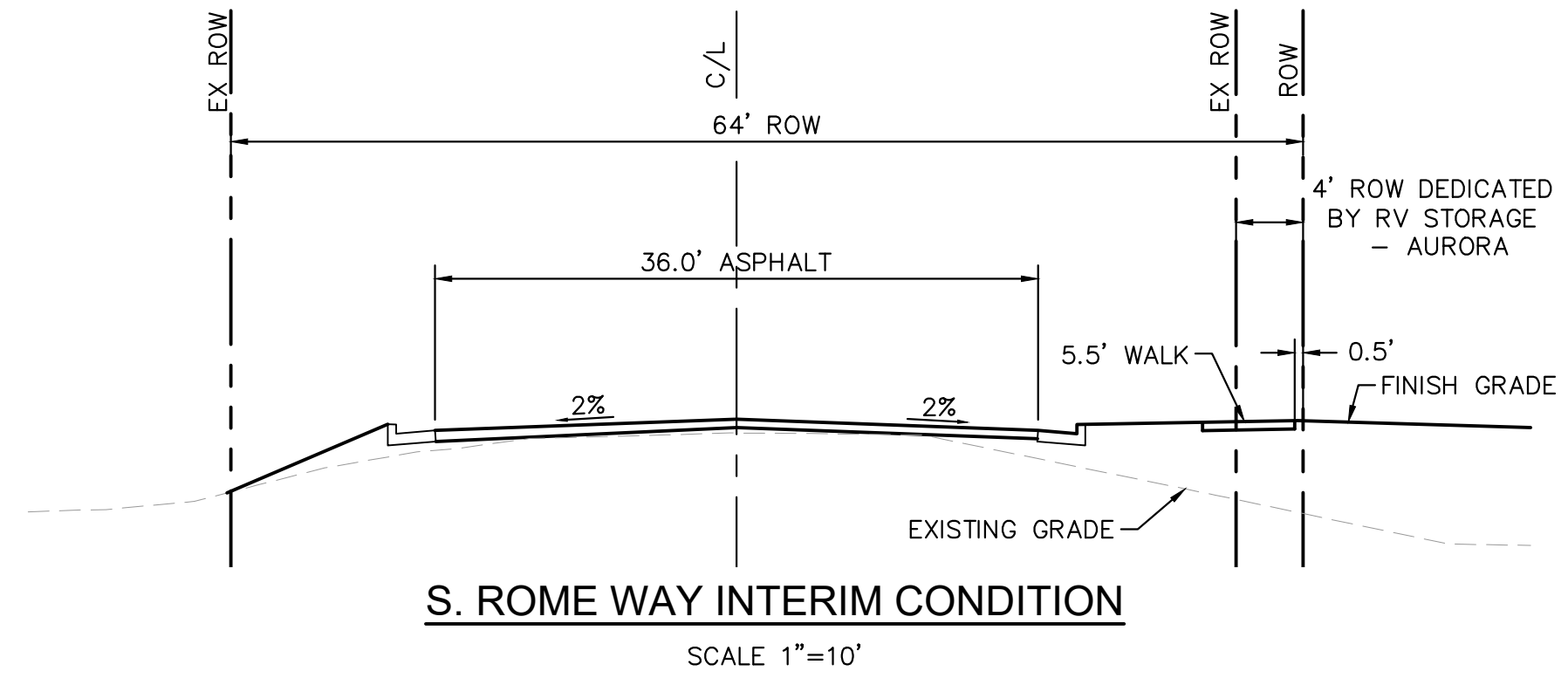
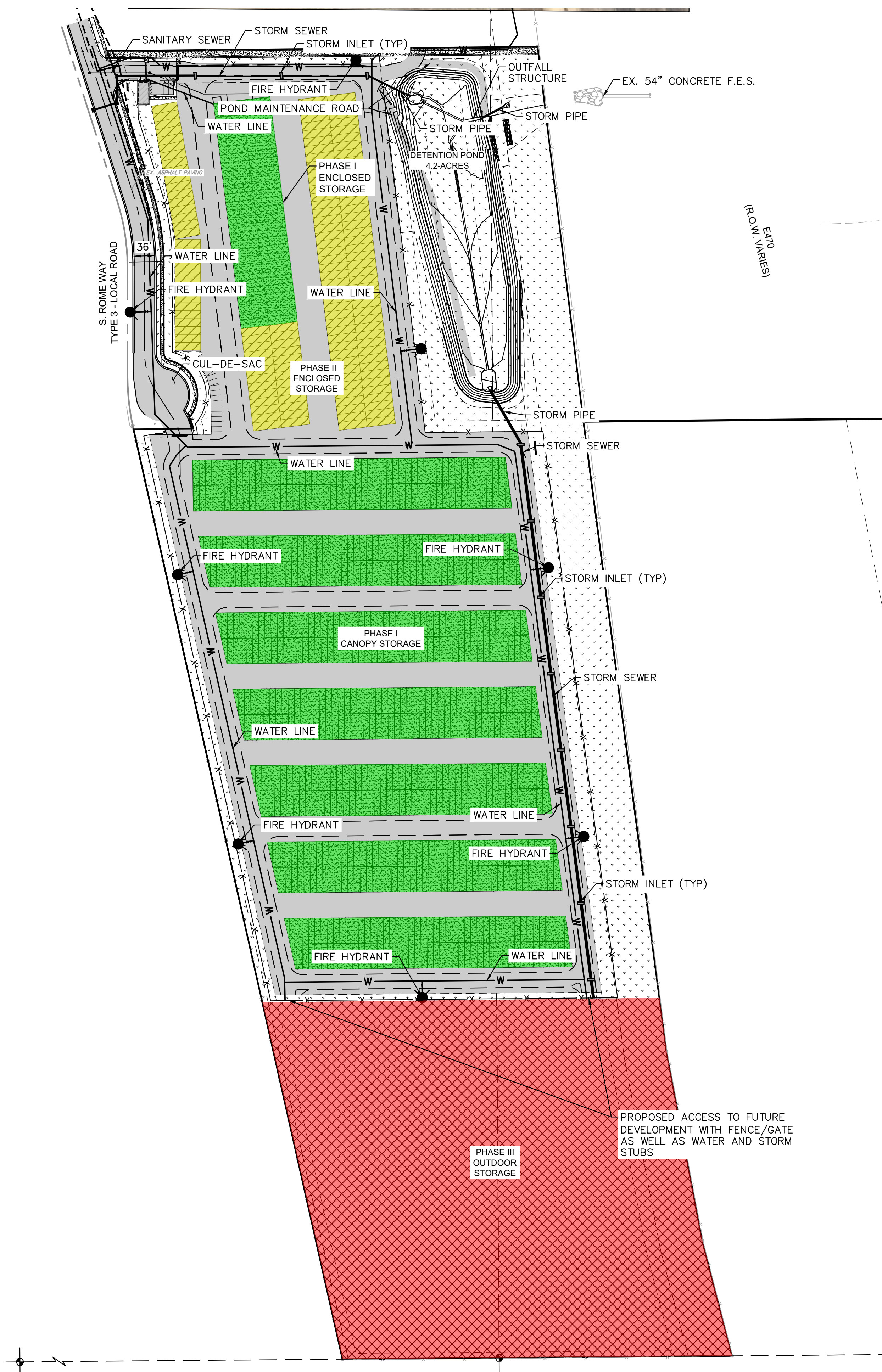

LEGEND

- EXISTING R.O.W. LINE
- PROPOSED SITE PROPERTY LINE
- SECTION LINE
- EASEMENT LINE
- X CEDAR FENCE
- PROPOSED STORM DRAINAGE INLET
- PROPOSED STORM OUTLET
- PROPOSED LANDSCAPE
- SITE PAVEMENT
- PHASE I
- PHASE II
- PHASE III

- PUBLIC IMPROVEMENTS:**
(BELOW WILL BE CONSTRUCTED IN PHASE I)
- EXISTING S. ROME WAY WILL REQUIRE A CUL-DE-SAC AT THE SOUTH END OF THE ROAD IN ADDITION TO IMPROVEMENTS INCLUDING CURBSIDE LANDSCAPING AND STREET LIGHTS.
 - A WATER SUPPLY LOOP TO BE INSTALLED UNDERNEATH THE OUTSIDE DRIVE AISLE TO PROVIDE FIRE PROTECTION THROUGHOUT THE SITE. LOOP IS TO CONNECT TO EXISTING MAIN LOCATED NORTH OF THE SITE.
 - SANITARY SEWER EXTENSION IS TO SERVICE ON SITE DUMP STATION AND OFFICE BUILDING.
 - PUBLIC IMPROVEMENTS MUST BE COMPLETED AND ACCEPTED PRIOR TO THE COMMENCEMENT OF BUSINESS OPERATIONS.

- NARRATIVE:**
(BELOW WILL BE CONSTRUCTED IN PHASE I)
- 40' OF ROME WAY AND THE CUL-DE-SAC TO BE CONSTRUCTED WITH THIS DEVELOPMENT. SEE PLANS
 - PROPOSED DETENTION POND, TEMP STORM INLET AND POND OUTFALL STRUCTURES TO BE CONSTRUCTED WITH CURRENT DEVELOPMENT. SEE PLANS.
 - ALL UTILITIES IN ROME WAY AND THE WATER LINE RUNNING ADJACENT TO THE POND TO BE CONSTRUCTED WITH THIS DEVELOPMENT. SEE PLANS.

GRAPHIC SCALE IN FEET
0 60 120 240

NORTH

811 Know what's below.
Call before you dig.

KIMLEY»Horn	
© 2020 KIMLEY-HORN AND ASSOCIATES, INC. 4562 South Uister Street, Suite 1500 Denver, Colorado 80237 (303) 228-2300	
DESIGNED BY: SAL	NER07/01/20 SAL
DRAWN BY: NER	DATE: APPR
CHECKED BY: RJP	BY
DATE: 06/19/2020	REVISION
NO.	
RV STORAGE - AURORA AURORA, COLORADO MASTER PLAN PUBLIC IMPROVEMENT PLAN	
PROJECT NO. 096648001	
PUBLIC	
TAB #13	